

menox

Left Foot Accelerator

Manual



Congratulations! You have purchased a Menox Left Foot Accelerator. We wish you pleasant and safe driving experiences.

Contents: Section	Subject	Page
1	Table of Contents	
2	Introduction	3
3	General Information	3
4	Left Foot Accelerator	4
5	Instructions for use	5
6	Installation Instructions	6
6.1	Installation sequence	6
6.2	Location of Left foot Accelerator	7
6.3	Attaching the Left foot Accelerator to the fire wall	7
6.4	Attachment of wire to Gas pedal	8
6.5	Attachment of hinge to original pedal	9
6.6	Installation of the Kick-down switch	10
6.7	Blown up picture	11
7	Warranty	12
8	Certification	13



Manufacturer



Turvax Oy / Ltd

Tarjusojantie 9
FIN-90450 KEMPELE
FINLAND

Tel. +358 85 13624
Fax +358 8 5563803
e-mail: menox@menox.org



...for more top quality driving aids:

www.menox.org

2 Introduction

This instruction manual must be read and its instructions understood before installing and using the Menox left foot accelerator. Keep this manual for later use. If the manual is not correctly filled in, the manufacturer is released of liability. The manufacturer is not responsible for incorrect installation or wiring connections. For safety reasons, only Turvax Oy or a trained and authorized installer may install and service this product.

3 General Information

The Menox left foot accelerator is a driving aid developed for disabled drivers who do not have use of their right leg while driving. Menox is a safe and tested product. It can be installed into automatic vehicles and adjusted according to the driver's needs.

Left foot acceleration

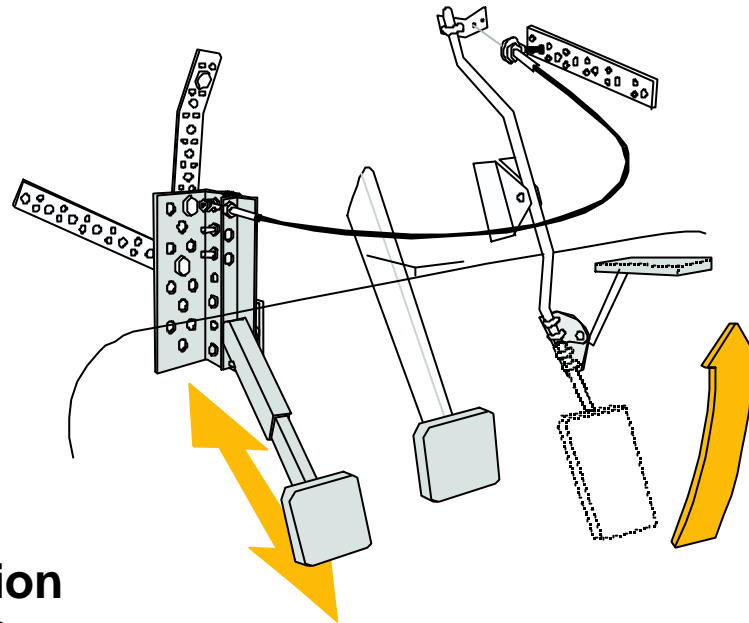
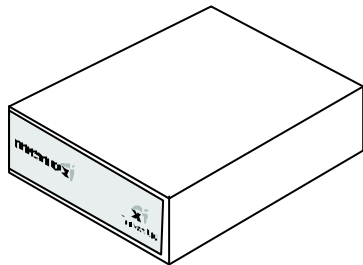

Right foot acceleration

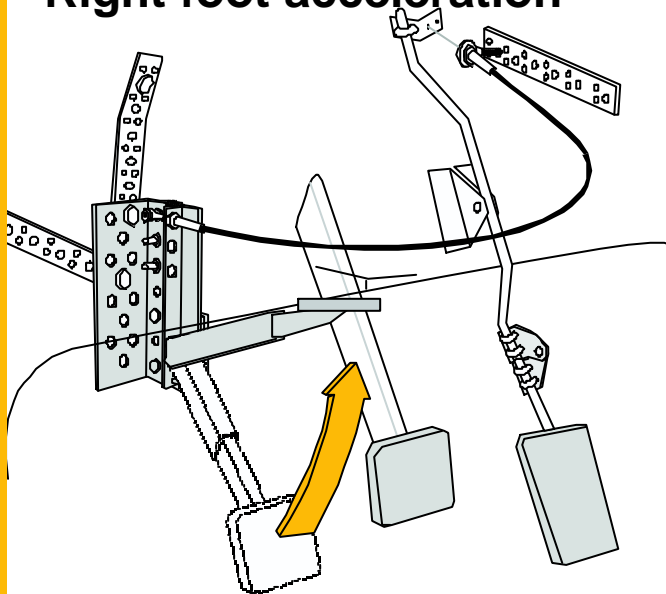

4 Leftfoot Accelerator

The Menox Left foot Accelerator was developed to control the cars original accelerator with the left foot. The Left foot accelerator is compatible with vehicles driven from either the right or left side of the vehicle.

The Menox pedal is universal and can be installed exceptionally into most makes and models.

When not in use, the left foot accelerator must be raised and likewise the original accelerator must be turned up when not applicable. The package contains a hinge allowing for the original accelerator to be turned up and away.

ATTENTION! It is important to turn the accelerator pedal, that is not in use, up and out of the way and ensure that it remains put.

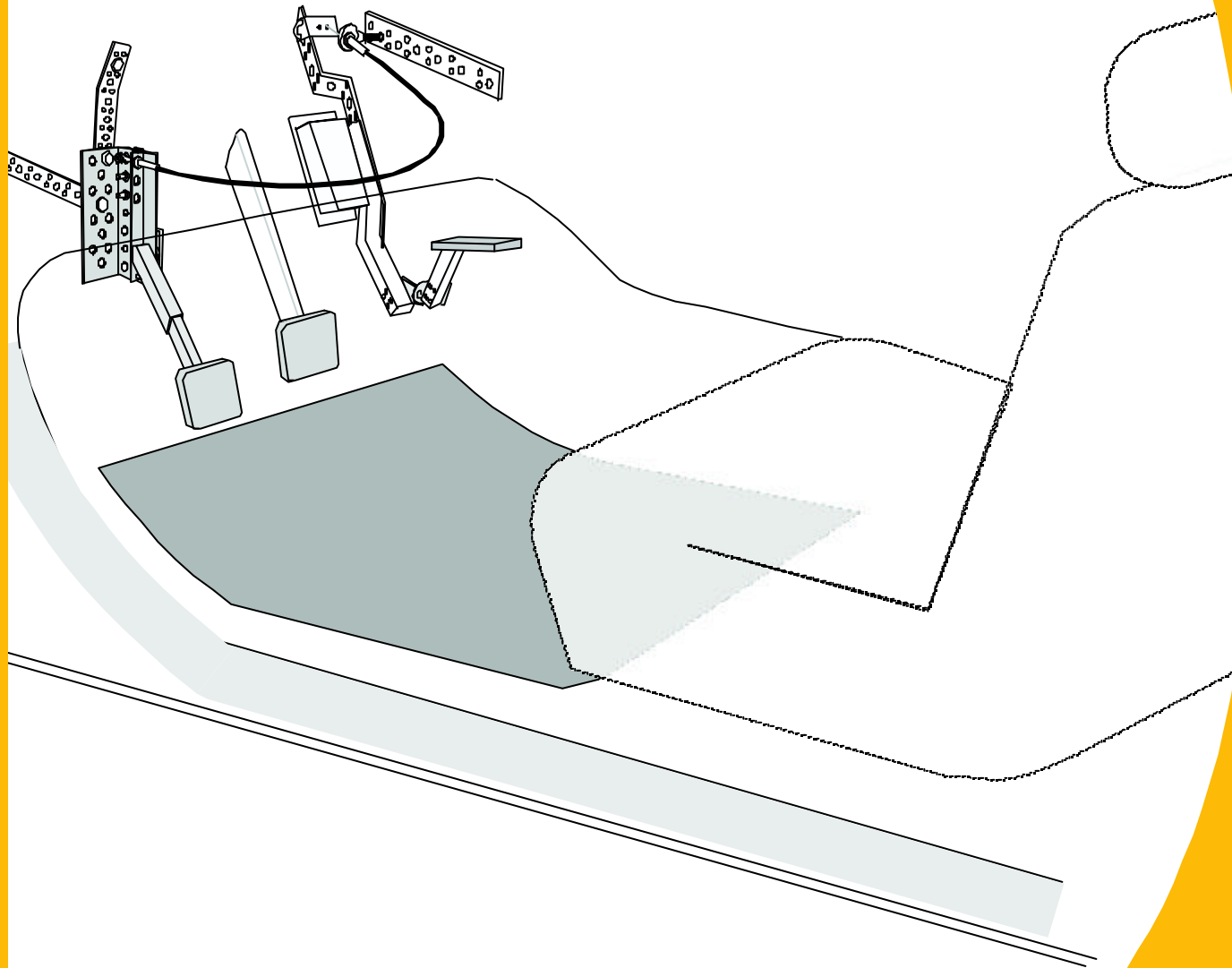

5 Instructions for use
The left foot accelerator enables for the normal use of the accelerator with the left foot. The motion of the pedal must be the same as in the original pedal.

In the case of an accident, the left foot accelerator cannot be used without the inspection of dealer or manufacturer.

If the device is for some reason too stiff or loose, immediately contact the installer. When exiting the car be careful that you don't come into excessive contact with the pedal.

Only persons authorized can use the left foot accelerator.

After installation, the vehicle must be inspected.

Driving with the left foot accelerator takes place just the same as with the vehicle's own pedals.

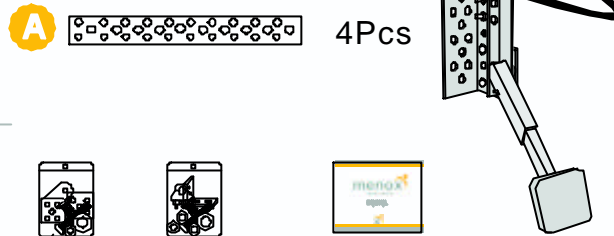
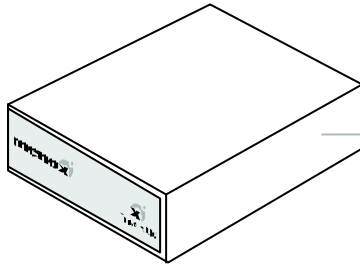

	Part	Pcs		Part	Pcs
B	Hinge	2	J	Cableplate	1
C	Hinge Backplate	3	K	Rod End	1
D	Wireclamp 5/16"	4	L	Wireclamp 5/16"	1
E	M8x20 ISO7380	1	M	Fastener	1
F	M6x40 DIN933	8	N	M8x25	2
G	M8 DIN985	1	O	M8x25 DIN933	2
H	M6 DIN985	16	P	M6x40 DIN933	1
I	A8 DIN6798-J	1	Q	M6x20 DIN933	2
			R	M8 DIN 985	2
			S	M6 DIN 985	5
			T	A6 DIN 9021	1
			U	A8 DIN 6798-J	2
			V	A6 DIN 6798-J	2

6 Installation instructions

Before beginning the installation process check that the product has not been damaged in delivery. Read the installation instructions fully before installation so that you can establish a clear picture of how the device works.

Make sure that the vehicle is properly secured preventing it from rolling during installation.

6.1 Installation sequence

1. Determine where to install the device.
2. Attaching the device to the firewall.
3. Attachment of hinge to original Gas pedal.
4. Attaching the cable
5. Kickdown switch connection (when necessary)
6. Final adjustments.

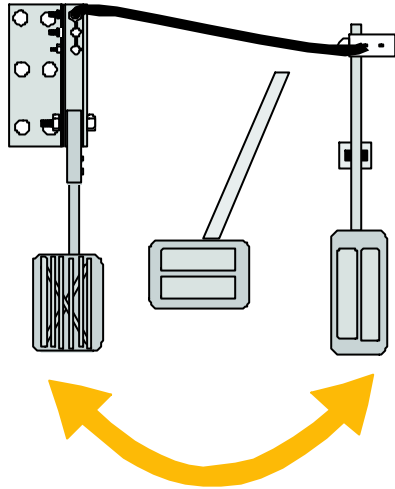

Fig 7.1

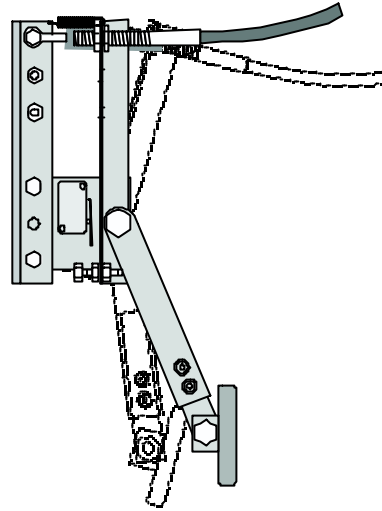

Fig 7.2

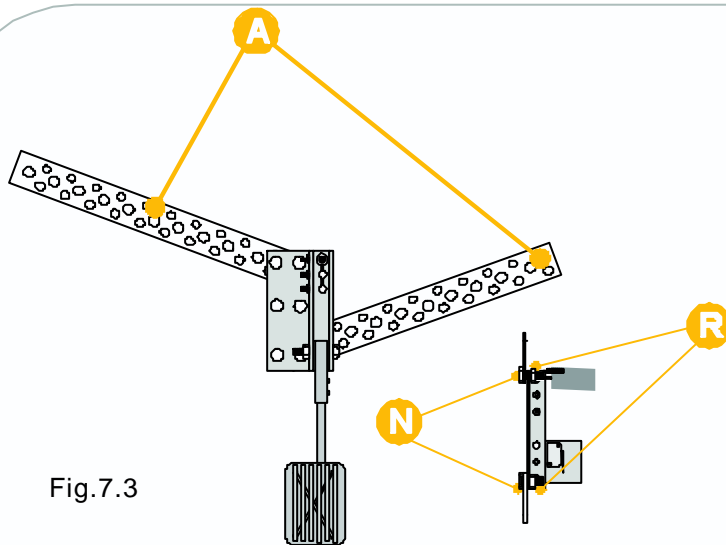

Fig.7.3

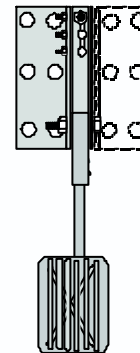

Fig 7.4

6.2 Location of Left foot accelerator
Begin by establishing a suitable place to install the Left foot accelerator.

Take into consideration the customers driving position, in order to establish the best placement of the left foot accelerator.

Installation of the Left foot accelerator strives to produce a mirror image of the original pedal as seen in figure 7.1

Insure that the height of installation is not too high. There must be room for the cable to move. (Fig 7.2)

6.3 Attaching the Left foot Accelerator to the firewall

Fasten assembly plate "A" to the shaft of the Left foot accelerator with bolt "N" or "O" and bolt "R"

Then fasten the assembly plate to the firewall. A suitable place on the firewall is, for example, at the base of the steering column. (Here you will often find a good place for fastening) (Fig. 7.3)

Flexibility in the location of the Left foot accelerator can be achieved by moving the pedal shaft to the other side of the accelerator plate shown in figure 7.4

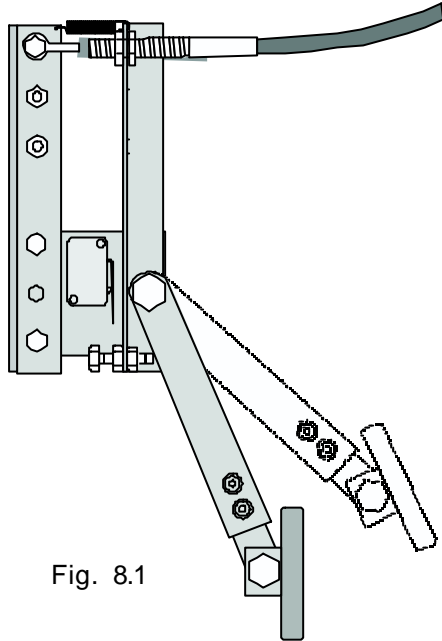

Fig. 8.1

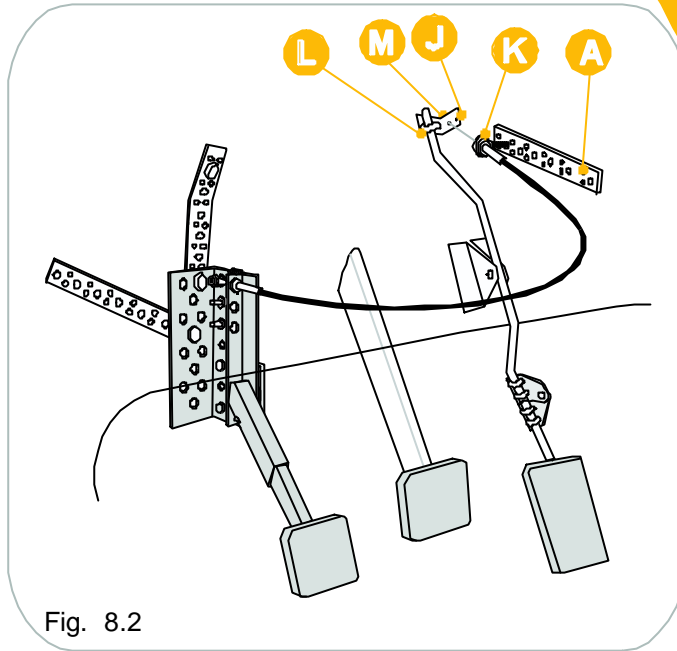

Fig. 8.2

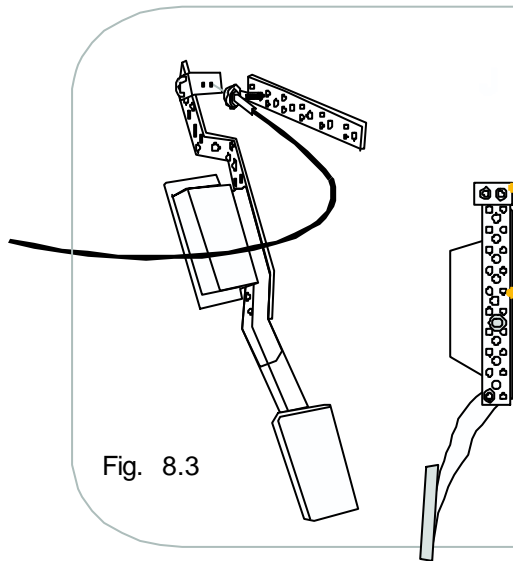

Fig. 8.3

The assembly plate is fastened under the pedals' original bolt. The bottom end of the assembly plate requires that you drill a 6mm hole, insert Allen bolt "P" through the whole in the assembly plate and the drilled hole and then insert washer "T" tighten with nut "S". The cable plate "J" is fastened to the top end of the assembly plate with Allen screw "Q".

6.4 Attaching the cable to the original Accelerator
The range of motion can be adjusted from both ends of the cable. Also the length and angle of the pedal are adjustable. (Fig 8.1) The angle of the pedal is controlled by an Allen screw. Make sure that the nut is tightened after the proper angle is achieved, preventing the screw from loosening and changing the pedal angle.

The fastening of the cable to the original pedal takes place for extending pedals as in fig 8.2 and for non-extending pedals in fig. 8.3. In the case of non-extending pedals, the assembly plate "A" is used to extend the shaft. Assembly plate "A" is fastened to the vehicle's frame. The rod end "K" is fastened to the assembly plate and the cable is strung through the rod end. The cable plate "J" is attached to the top of the Gas pedal with the cable clamp "L" and nut "H". The cable is then threaded through the cable plate "J" and then fastened with fastener "M".

The range of motion must be adjusted so that the left foot accelerator and the original accelerator pedal work simultaneously. I.e. they both accelerate fully when applied and vice versa when not applied.

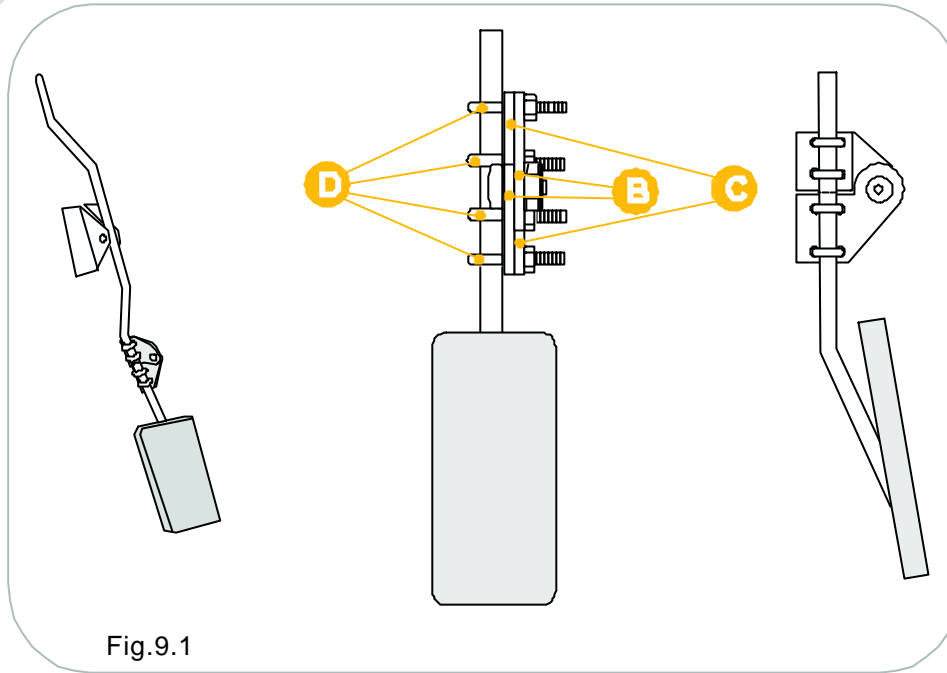

Fig.9.1

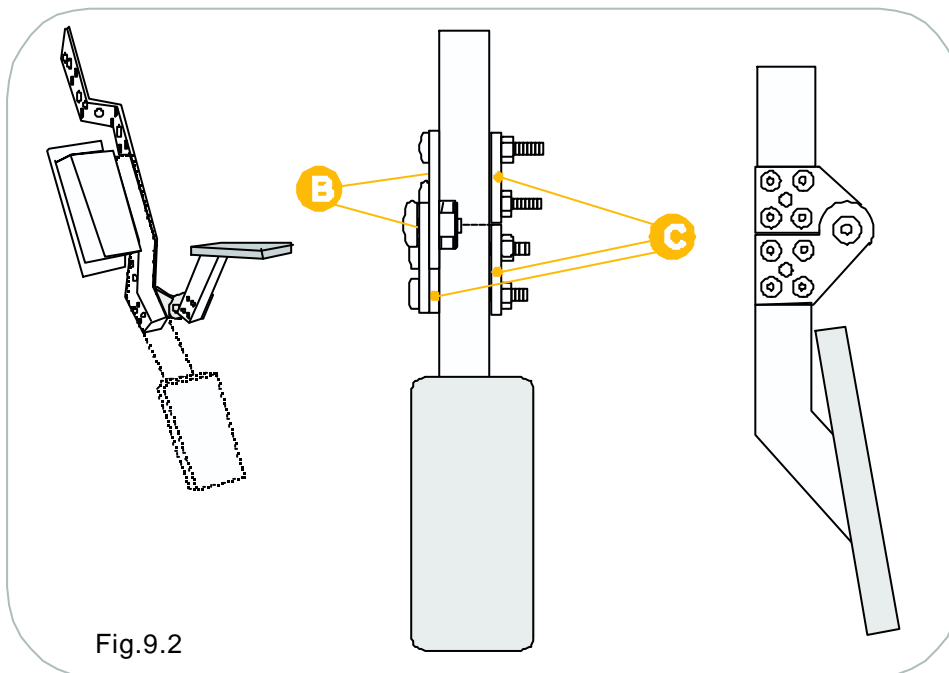

Fig.9.2

The hinge should be tightened so that it remains in a vertical position by itself.

6.5 Hinging the original Gas pedal

The use of the hinge is important, as the pedal in use, is the only pedal down. Fasten the hinge and cut the shaft of the pedal between the two hinges. Fasten the two hinges together with bolt "E" and nut "G".

There are two possible ways of attaching the hinge depending on the original gas pedal. If the shaft is for example round, where the cable locks fit around it, the application of the hinge should take place as in fig 9.1. Use nut "H" to tighten and fasten the cable clamp.

In the case that the cable clamp method can not be used, drill holes through the shaft of the original pedal as in fig. 9.2. Use bolt "F" and nut "H" for fastening the hinge to the original shaft.

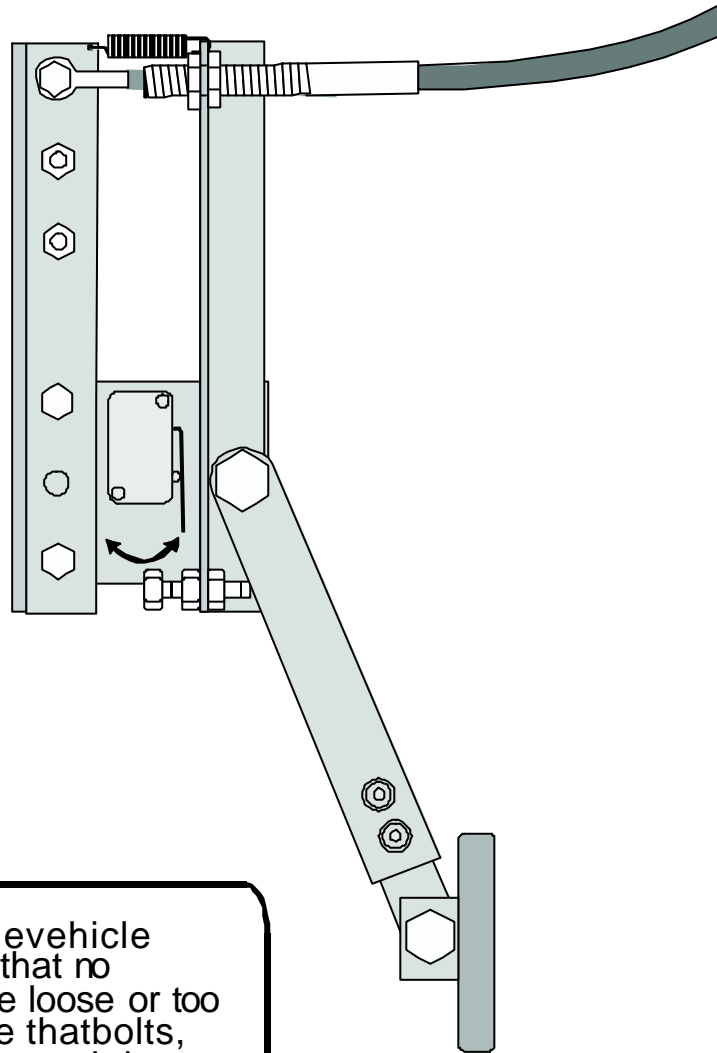

Always check the vehicle when serviced, that no moving parts are loose or too tight. Also insure that bolts, nuts and screws are tight enough. Check the working order of the kick-down switch.

6.6 Assembly of the kick-down switch.
The option of the kick-down switch comes with the pedal. This option is connected to work in place of the original kick down, as when the left foot accelerator is down, the original pedal is up and therefore the original kick down cannot be activated from the original pedal.

The position of the kick-down switch can be moved by loosening the switch screws and moving it to the desired position. Remember to re-tighten the screws.

Insure the working order of the Left foot accelerator and kick-down switch by test driving the vehicle. Also make final adjustments according to the customers' needs.

Blown up picture of the
Left foot accelerator.

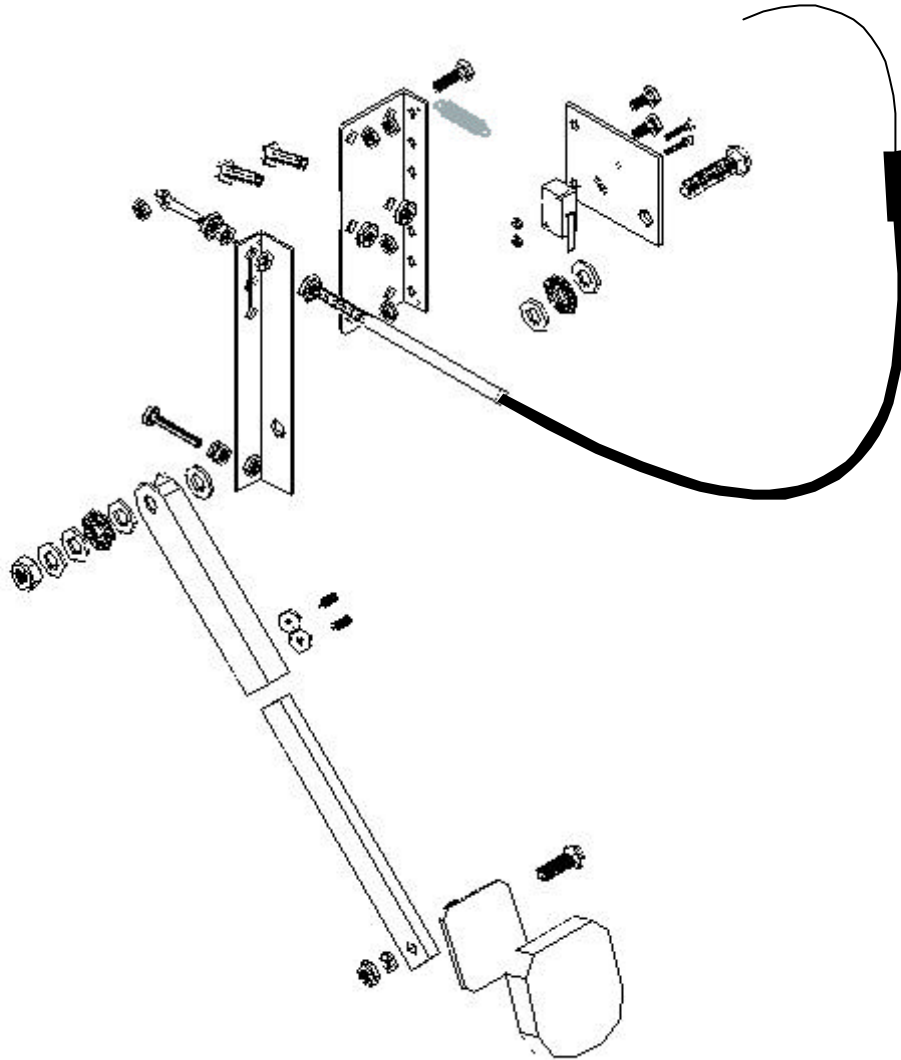

7 Menox warranty

7.1 Duration and terms of warranty

7.1.1 Duration of warranty

a) We guarantee a warranty of up to three years for the product if it has been installed into a new vehicle.

b) We guarantee a warranty of up to two years if the product has been installed in an old car

7.1.2 Extent

Our warranty covers all faults occurring during manufacturing and materials.

7.2 Terms

The warranty is valid provided that:

a) Installation is performed by an authorized mechanic.

b) A warranty repair be negotiated by the manufacturer/dealer of the product prior to action of repair

c) The use, maintenance and physical conditions in which the product has been used have been consistently normal and the operation instructions have been followed and scheduled servicing has been performed.

7.3 Proper actions in warranty cases

In warranty cases, always contact a garage or mechanic authorized to perform the warranty repair.

7.3.1 The defective product is returned to the manufacturer and after they have examined it, the repaired or new product is sent to the customer.

7.3.2 In the case that there is need for compensation for work, it must be negotiated with the manufacturer. Compensation can amount to a maximum of one (1) hour at the regular rate of the garage/mechanic. Compensation is paid as a reduction from the purchase bill/receipt.

7.3.3 The warranty does not cover indirect costs such as shipping or travel expenses or malfunctions caused by normal wear.

Manufacturer's Certificate

I certify that the Menox Left Foot Accelerator has been designed and manufactured in Turvax Oy, Kempele Finland. Throughout the design and manufacturing, special attention has been placed on safety and ease of use of the product. Menox Left Foot Accelerators are manufactured in accordance with Finnish guidelines (703/98) 103§, ISO/TC22/WG4 and EU directives (74/60/ETY, 78/632/ETY).

Respectfully yours,

Juha Paananen

CEO

Left Foot Accelerator
Serial Nr. Sticker

We reserve all rights to product changes. Kuvat ovat viitteellisiä, eikä näinollen välttämättä vastaa todellista asennusta.